

GTS V2 1202.5-11500KV

Technical Datas	
KV	11500
Configu-ration	9N12P
Stator Diamter	12mm
Stator Length	2.5mm
Shaft Diameter	2mm
Motor Dimension(Dia.*Len)	Φ 15.95*9.1mm
Weight(g)	3.9(3cm wire)
Idle current(10)@10V(A)	1.3
No.of Cells(Lipo)	1~2S
Max Continuous Power(W)3S	88
Internal Resistance	135mΩ
Max Current(3S)	12A
Max.Efficiency Current	(1-3A)>83%

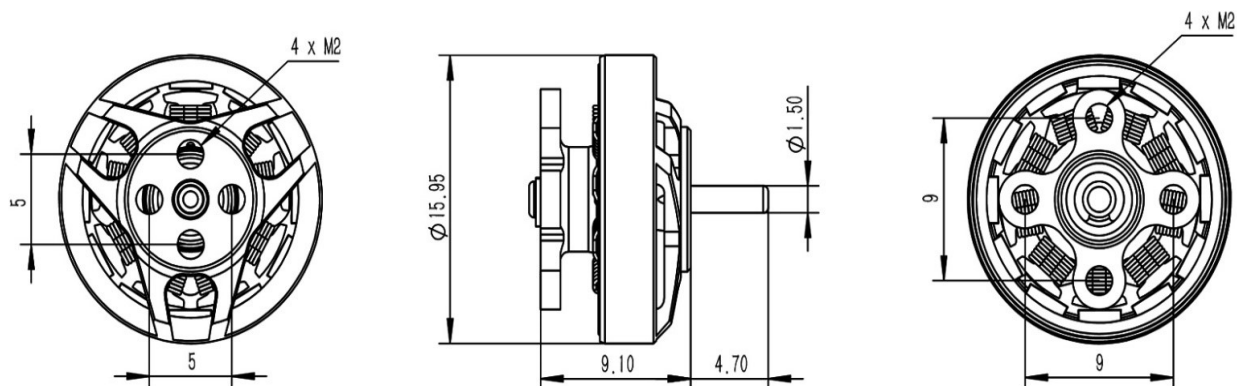

Prop (inch)	Voltages (V)	Throttle (%)	Load Current (A)	Pull(g)	Power(W)	Efficiency(g/W)	Temperature(in full throttle load 3's)
GF 65R	3.7	50%	1.15	44	4.3	10.341	65°C
		100%	4.9	116	18.1	6.398	
	7.4	50%	2.4	86	17.8	4.842	75°C
		100%	9.6	223	71.0	3.139	
HQ T65R	3.7	50%	1.7	44	6.3	6.995	68°C
		100%	5.9	118	21.8	5.405	
	7.4	50%	3.5	89	25.9	3.436	85°C (Hot)
		100%	12	227	88.8	2.556	
HQT3x2R	3.7	50%	2.3	61	8.5	7.168	73°C
		100%	8.4	136	31.1	4.376	
GF3108	3.7	50%	2.3	59	8.5	6.933	73°C
		100%	8.3	133	30.7	4.331	

■ Airplane

□ Helicopter

■ Vtol